



# Lake Murray State Park

Experience southern comfort at Oklahoma's first and largest state park, located on the shores of beautiful, crystal-clear Lake Murray.

Enjoy the lodge, which provides the perfect meeting space, ballroom and accommodations for reunions, special events or leadership conferences. Additional lodging includes 58 park cabins for a remote experience.

Lake Murray is an outdoor adventure-seeker's dream. With more than 12,000 acres of forested rolling hills, the park features an 18-hole golf course, ATV trails, horseback riding and more. The landmark Tucker Tower sits high above the bluff, overlooking the spring-fed aqua waters of the lake. Large pavilions scattered throughout the park provide a shady gathering spot for reunions or large groups to relax, enjoy conversation and a meal cooked on the grill.

A drive through the park showcases the rich history that exists within the buildings and structures – the most visible reminders of the work accomplished by the Civilian Conservation Corps when the park was built in the 1930s. Step back into a beautiful reflection of the past and create new memories with your group at Lake Murray State Park.



## ACTIVITIES / ATTRACTIONS

- 5,728 ACRE LAKE
- 12,496 PARK ACRES
- 18-HOLE GOLF COURSE/PAR 72
- PRO SHOP/ON-SITE PGA PRO
- FISHING/BOATING/WATERSPORTS
- TUCKER TOWER HISTORICAL MUSEUM
- LAKE MURRAY NATURE CENTER
- NATURE PROGRAMS/NATURALIST
- PAVED ACCESSIBLE MULTI-USE TRAIL
- GUIDED TRAIL RIDES & STABLE HAYRIDES
- WATER SPORTS & MINIATURE GOLF
- LAKE CRUISES/WATERCRAFT RENTALS
- SWIMMING POOL & SPLASH PAD
- ATV/MOTORCYCLE TRAILS
- MARINA/BOAT RENTALS
- HISTORIC STRUCTURES BUILT BY THE CIVILIAN CONSERVATION CORPS IN THE 1930S

## AMENITIES

- MAIN LODGE (16-PLEX/SLEEPS 64)
- POD A (8-PLEX/SLEEPS 32)
- POD B (8-PLEX/SLEEPS 32)
- 58 CABINS WITH KITCHENETTES
- SOME WITH FIREPLACES
- 9 CAMPGROUNDS
- ONLINE RV RESERVATIONS SITE  
WWW.TRAVELOK.COM
- 2 GROUP CAMPS – SEASONAL
- GROUP CAMPGROUND
- 330 RV/300 CAMPSITES
- GIFT SHOP
- ROAD RUNNER FITNESS CENTER
- WIFI AVAILABLE IN LODGE

## MEETING GROUP / FACILITIES

- 8 MEETING ROOMS AVAILABLE
- + PRE-FUNCTION AREAS
- BALD EAGLE RECEPTION HALL (4186 S.F.) (3 BREAKOUT ROOMS)
- BANQUET CATERING
- GROUP PICNIC PAVILIONS W/GRILLS

## AUDIO / VIDEO EQUIPMENT

- SOUND SYSTEM
- SMART TVS WITH VIDEO PLAYER
- DIGITAL PROJECTOR/
- PROJECTION SCREENS
- PORTABLE STAGES
- PODIUMS
- EASELS

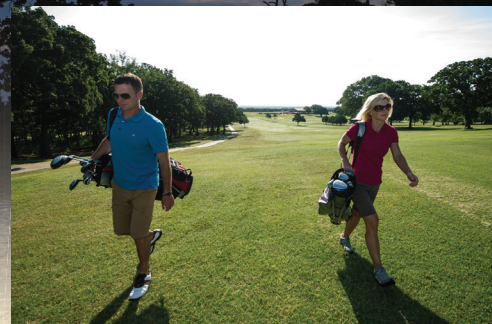
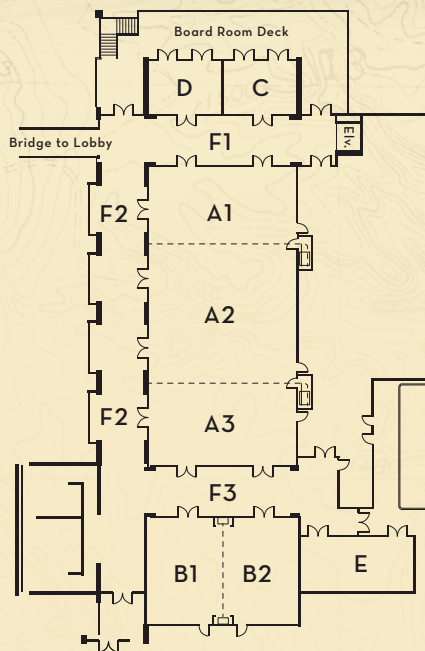

## ROOM DIMENSIONS

|    |                               | Dimensions    | Sq. Ft.                                      | Theater | Classroom | Conference | U-Shape | Rounds | Banquet |
|----|-------------------------------|---------------|--|---------|-----------|------------|---------|--------|---------|
| A  | Bald Eagle Reception Hall     | 45'7" x 91'6" | 4186   | 480     | 280       | N/A        | N/A     | 280    | 360     |
|    | Section 1                     | 45'7" x 24'2" | 1106   | 140     | 70        | 40         | 35      | 60     | 114     |
|    | Section 2                     | 45'7" x 42'   | 1919   | 190     | 120       | 58         | 50      | 96     | 170     |
|    | Section 3                     | 45'7" x 25'4" | 1160   | 150     | 80        | 45         | 40      | 66     | 124     |
| B  | Hummingbird Mtg. Room         | 46' x 32'4"   | 1490   | 140     | 100       | 50         | 50      | 100    | 112     |
|    | Section 1                     | 23' x 32'4"   | 745  | 70      | 50        | 28         | 25      | 50     | 60      |
|    | Section 2                     | 23' x 32'4"   | 745  | 70      | 50        | 28         | 25      | 50     | 60      |
| C  | Mallard Board Room            | 22' x 15'10"  | 332  | N/A     | N/A       | 14         | N/A     | N/A    | N/A     |
| D  | Gadwall Board Room            | 22' x 15'10"  | 332  | N/A     | N/A       | 14         | N/A     | N/A    | N/A     |
| E  | Oriole Hospitality Room       | 17'2" x 34'2" | 588  | 50      | 35        | 24         | 18      | 30     | 45      |
| F1 | Pre-Function Area East (Lake) | 12'8" x 46'1" |  |         |           |            |         |        |         |
| F2 | Pre-Function Area North       | 13' x 132'10" | Area will accommodate 16 - 8ft vendor tables |         |           |            |         |        |         |
| F3 | Pre-Function Area West        | 14'6" x 47'7" |  |         |           |            |         |        |         |

### OKLAHOMA STATE PARKS

123 ROBERT S. KERR  
OKLAHOMA CITY, OK 73102  
OSPCUSTOMERSERVICE@TRAVELOK.COM  
405-522-9986

LAKE MURRAY STATE PARK IS LOCATED HALFWAY BETWEEN  
OKLAHOMA CITY AND DALLAS, 2 MILES EAST OF I-35 AT EXIT 24.

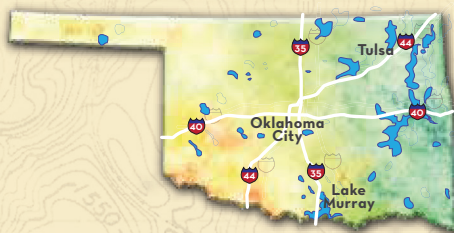

### LAKE MURRAY LODGE

3323 LODGE ROAD  
ARDMORE, OK 73401  
RESERVATIONS: 800-257-0322  
580-223-6600  
PARK OFFICE: 580-223-4044  
PRO SHOP: 580-223-6613  
LAKEMURRAYRESORT@TRAVELOK.COM

**OKLAHOMA**  
STATE PARKS

ONLINE RESERVATIONS AVAILABLE AT  
**TRAVELOK.COM**