

Lake Murray

STATE PARK

Experience southern comfort at Oklahoma's first and largest state park located on the shores of beautiful Lake Murray.

Enjoy the lodge, which provides the perfect meeting space, ballroom and accommodations for reunions, special events, or leadership conferences. Additional lodging includes fifty-seven park cabins for a remote experience.

Lake Murray is an outdoor adventure-seeker's dream. With more than 12,000 acres of forested rolling hills, the park features an 18 hole golf course, ATV trails, horseback riding and more. The landmark Tucker Tower sits high above the bluff overlooking the spring-fed aqua waters of the lake. Large pavilions scattered throughout the park provide a shady gathering spot for reunions or large groups to relax, enjoy conversation and a meal cooked on the grill.

A drive through the park showcases the rich history that exists within the buildings and structures - the most visible reminders of the work accomplished by the Civilian Conservation Corps when the park was built in the 1930's. Step back into a beautiful reflection of the past and create new memories with your group at Lake Murray State Park.





ACTIVITIES/ATTRACTIONS

- 5,728 ACRE LAKE
- 12,496 PARK ACRES
- 18 HOLE GOLF COURSE/PAR 72
- PRO SHOP/ON-SITE PGA PRO
- FISHING/BOATING/WATERSPORTS
- TUCKER TOWER HISTORICAL MUSEUM
- LAKE MURRAY NATURE CENTER
NATURE PROGRAMS/NATURALIST
- PAVED ACCESSIBLE MULTI-USE TRAIL
- GUIDED TRAIL RIDES & STABLE
HAYRIDES
- WATER SPORTS & MINIATURE GOLF
LAKE CRUISES/WATERCRAFT RENTALS
- SWIMMING POOL & SPLASH PAD
- TENNIS & BASKETBALL COURT
- ATV/MOTORCYCLE TRAILS
- MARINA/BOAT RENTALS
- HISTORIC STRUCTURES BUILT BY THE
CIVILIAN CONSERVATION CORPS IN
THE 1930'S



AMENITIES

- MAIN LODGE MEADOWLARK
(16-PLEX/SLEEPS 64)
- NORTH BUILDING MOCKINGBIRD
(8-PLEX/SLEEPS 32)
- SOUTH BUILDING SCISSORTAIL
(8-PLEX/SLEEPS 32)
- 57 CABINS WITH KITCHENETTES.
SOME WITH FIREPLACES
- 9 CAMPGROUNDS
- ONLINE RV RESERVATIONS SITE
WWW.GOCAMPOK.COM
- 3 GROUP CAMPS - SEASONAL
- GROUP CAMPGROUND
- 330 RV/300 CAMPSITES
- BLUE HERON RESTAURANT
INDOOR/OUTDOOR SEATING
- GIFT SHOP
- ROAD RUNNER FITNESS CENTER

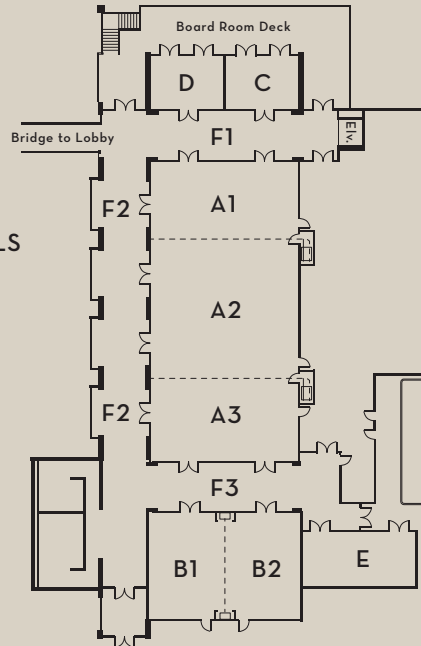

ROOM DIMENSIONS

| | | Dimensions | Sq. Ft. | Theater | Classroom | Conference | U-Shape | Rounds | Banquet |
|----|-------------------------------|-------------|--|---------|-----------|------------|---------|--------|---------|
| A | Bald Eagle Reception Hall | 45'7"x91'6" | 4186 | 480 | 280 | N/A | N/A | 280 | 360 |
| A1 | Section 1 | 45'7"x24'2" | 1106 | 140 | 70 | 40 | 35 | 60 | 114 |
| A2 | Section 2 | 45'7"x42' | 1919 | 190 | 120 | 58 | 50 | 96 | 170 |
| A3 | Section 3 | 45'7"x25'4" | 1160 | 150 | 80 | 45 | 40 | 66 | 124 |
| B | Hummingbird Mtg. Room | 46'x32'4" | 1490 | 140 | 100 | 50 | 50 | 100 | 112 |
| B1 | Section 1 | 23'x32'4" | 745 | 70 | 50 | 28 | 25 | 50 | 60 |
| B2 | Section 2 | 23'x32'4" | 745 | 70 | 50 | 28 | 25 | 50 | 60 |
| C | Mallard Board Room | 22'x15'10" | 332 | N/A | N/A | 14 | N/A | N/A | N/A |
| D | Gadwall Board Room | 22'x15'10" | 332 | N/A | N/A | 14 | N/A | N/A | N/A |
| E | Oriole Hospitality Room | 17'2"x34'2" | 588 | 50 | 35 | 24 | 18 | 30 | 45 |
| F1 | Pre-Function Area East (Lake) | 12'8"x46'1" | | | | | | | |
| F2 | Pre-Function Area North | 13'x132'10" | Area will accommodate 16 - 8ft vendor tables | | | | | | |
| F3 | Pre-Function Area West | 14'6"x47'7" | | | | | | | |

MEETING GROUP/FACILITIES

- 8 MEETING ROOMS AVAILABLE
+ PRE-FUNCTION AREAS
- BALD EAGLE RECEPTION HALL (4186 s.f.)
(3 BREAKOUT ROOMS)
- BANQUET CATERING
- GROUP PICNIC PAVILIONS W/GRILLS

AUDIO/VIDEO EQUIPMENT

- SOUND SYSTEM
- SMART TV'S WITH VIDEO PLAYER
- DIGITAL PROJECTOR/PROJECTION SCREENS
- PORTABLE STAGES
- PODIUMS
- EASELS

OKLAHOMA STATE PARKS

P.O. Box 52002
Oklahoma City OK 73152
800-652-6552
www.TravelOK.com
Sales@TravelOK.com

Lake Murray State Park is located halfway between Oklahoma City and Dallas, 2 Miles East of I-35 at Exit 24.

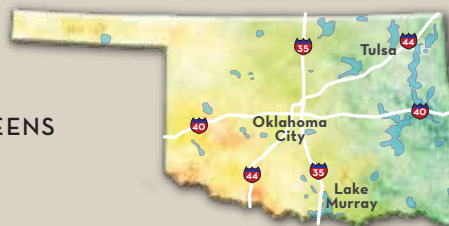

LAKE MURRAY LODGE

3323 Lodge Road
Ardmore, OK 73401
Reservations: 800-257-0322
580-223-6600

Park Office: 580-223-4044
Pro Shop: 580-223-6613
LakeMurrayResort@TravelOK.com



Online Reservations Available At
www.TravelOK.com