

**LEGEND**

- U.S. NUMBERED HIGHWAY
- STATE NUMBERED HIGHWAY
- INTERSTATE HIGHWAY ROUTE
- PAVED ROAD
- GRAVEL ROAD
- UNIMPROVED ROAD
- PRIVATE ROAD
- PROJECTED ROAD
- RESIDENTIAL ROAD
- COUNTY ROAD ID NO.
- MILEAGE BETWEEN POINTS
- DIVIDED HIGHWAY 4 OR MORE LANES
- UNDIVIDED HIGHWAY 3 OR MORE LANES
- TRAFFIC CIRCLE
- HIGHWAY GRADE SEPARATION
- TRAFFIC INTERCHANGE
- STATE LINE
- COUNTY LINE
- CIVIL TOWNSHIP LINE
- SECTION LINE
- RURAL DEVELOPMENT AREA
- GOVERNMENT PROPERTY LINE
- MATCH LINE
- COUNTY SEAT
- CORPORATE LIMITS
- CIVIL TOWNSHIP ROAD IN PLACE
- INSET BOUNDARY
- ELEVATION ABOVE SEA LEVEL
- MOUNTAIN RANGE, BUTTE OR MESA
- SMALL MONUMENT
- MARSH OR SWAMP LANDS
- DRAINAGE DITCH
- IRRIGATION DITCH
- LAKE, RESERVOIR OR POND WITH DAM
- ROAD OVER DAM
- DRY LAKE SUBJECT TO FLOOD
- SMALL BRIDGES CLOSELY SPACED
- HIGHWAY BRIDGE OVER 20FT. IN LENGTH
- GENERAL BRIDGE, LOW CROSSING
- ARCH BRIDGE
- TRUSS BRIDGE-WOOD, STEEL, CONCRETE
- CONCRETE EPF OR FIELD
- FORD ROAD ESTABLISHED
- INTERMITTENT STREAM
- NARROW STREAM
- DOCK, PIER OR LANDING
- NAVIGABLE STREAM WITH LOCK & DAM
- WIDE STREAM OR RIVER
- TRIANGULATION STATION
- RAILROAD WITH STATION INDICATED
- GRADE CROSSING
- UNDERPASS, E.A. BRIDGE
- OVERPASS, A.A. BELOW
- RAILROAD ON STREET
- MILITARY AIRFIELD
- AIRPORT WITH COMPLETE FACILITIES
- AIRPORT WITH LIMITED FACILITIES
- LANDING STRIP, PRIVATE FIELD
- AIRPORT, GENERAL OUTLINE OF FIELD RUNWAYS SHOWN IN POSITION
- ROADSIDE PARK, Picnic Grounds
- PARKGROUNDS
- BATHING BEACH OR SWIMMING POOL
- SCENIC SITE
- MOTEL
- CAMP OR LODGE, Permanent with Buildings
- TRAFFIC CIRCLE
- SMALL PARK
- FOREST RANGER STATION
- OBSERVATION OR LOOKOUT TOWER
- CAMP SITE
- FISH HATCHERY
- GOLF COURSE OR COUNTRY CLUB
- ATHLETIC FIELD OR AMUSEMENT PARK
- PARKGROUNDS, RACE COURSE
- DWELLING
- NUMBER OF DWELLINGS CLOSELY SPACED
- COMBINED BUSINESS AND DWELLING
- POST OFFICE
- POST OFFICE COMBINATIONS
- SEASONAL DWELLINGS
- CHURCH OR OTHER RELIGIOUS BUILDING
- CEMETERY
- CHURCH WITH CEMETERY ADJACENT
- REST HOME
- HOSPITAL
- SMALL BUSINESS
- INDUSTRY
- SAW MILL
- MINE SHAFT OR DRIFT
- OIL OR GAS FIELD
- GAUGING OR PUMPING STATION
- WAREHOUSE
- GRAVEL PIT
- QUARRY
- SCHOOL
- COMMUNITY HALL OR LODGE
- DRIVE-IN THEATER
- CORRECTIONAL INSTITUTION
- HIGHWAY GARAGE
- JUNK YARDS & CLUMPS A-Automobile
- Scrap Building Material
- Debris, Garbage or Trash Dump
- F-Station, FL, G-Other
- SEWAGE DISPOSAL PLANT
- WATER SUPPLY STAND PIPE
- POWER PLANT
- BOOSTER STATION
- POWER SUBSTATION
- TELEVISION OR RADIO STATION
- MILITARY INSTALLATION

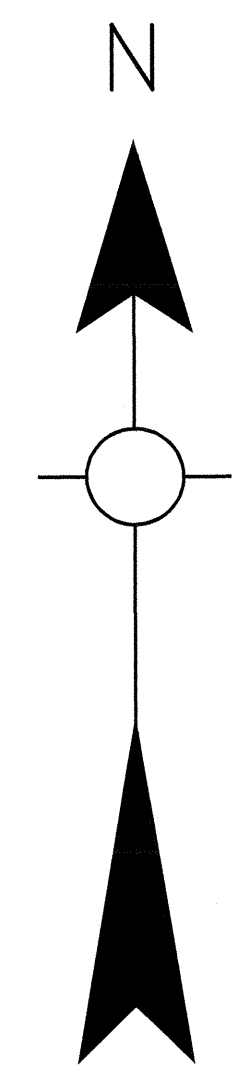

GENERAL HIGHWAY MAP  
**KIOWA COUNTY**  
 OKLAHOMA

PREPARED BY THE  
 OKLAHOMA DEPARTMENT OF TRANSPORTATION  
 PLANNING DIVISION

IN COOPERATION WITH THE  
 U.S. DEPARTMENT OF TRANSPORTATION  
 FEDERAL HIGHWAY ADMINISTRATION

SCALE IN MILES

SCALE IN KILOMETERS

ALL DATA CURRENT TO  
 DATE OF INVENTORY  
 NOVEMBER 1999  
 ORIGINAL DRAFTING BY J.A.V. APRIL 2002  
 STATE SYSTEM REVISED TO APRIL 2002

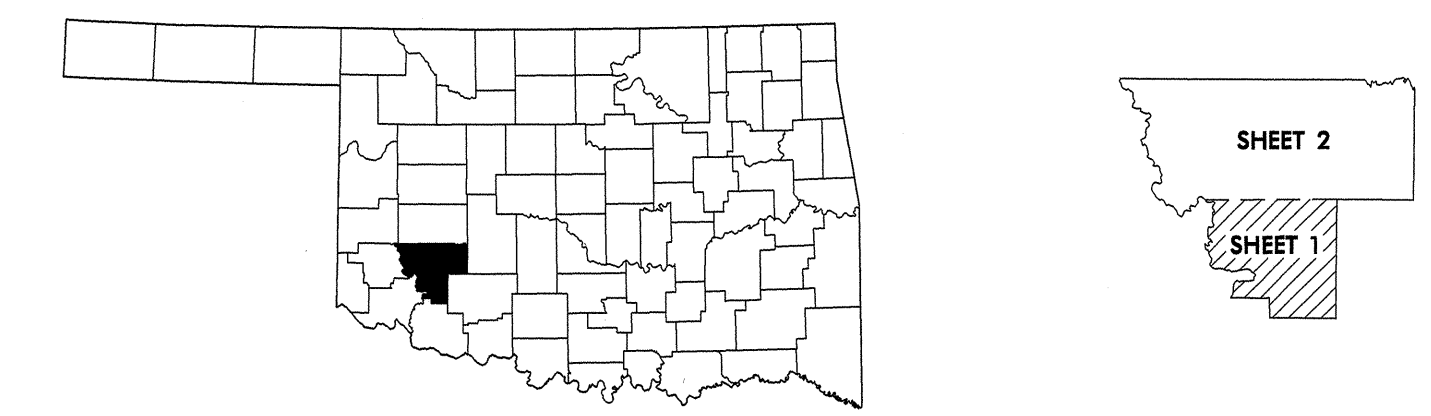

Copies of this map are available for public use at nominal cost. This map indicates those roads known to the Department to be open to public travel. Placement of a road on the map has no relationship to maintenance responsibility by any level of government.  
 Address: OKLAHOMA DEPARTMENT OF TRANSPORTATION  
 REPRODUCTION BRANCH Phone (405) 521-2586  
 200 N.E. 21st STREET  
 OKLAHOMA CITY, OKLAHOMA 73105-3204

NOT FOR RESALE

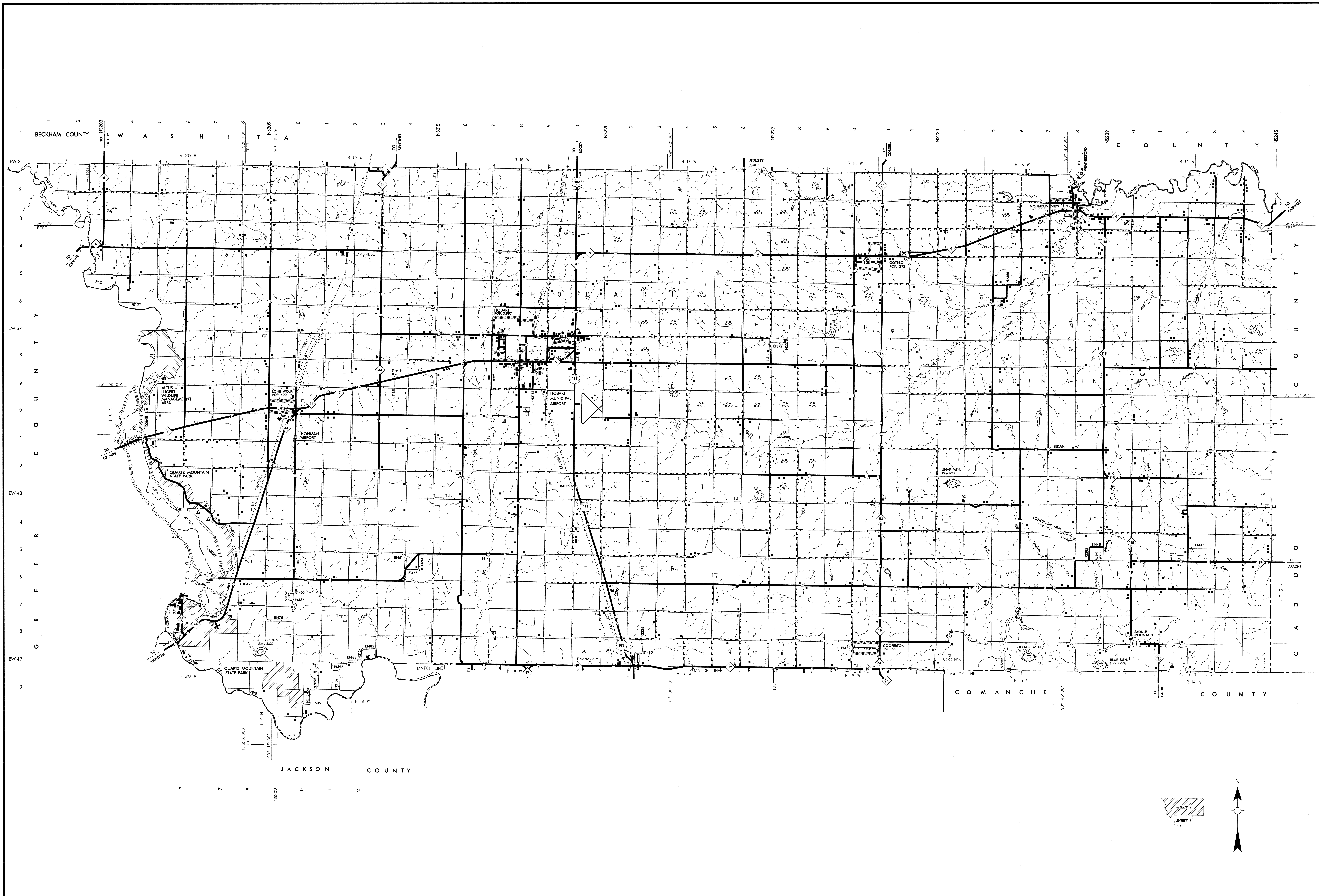

Copies of this map are available for public use at nominal cost. This map indicates those roads known to the Department to be open to public travel. Placement of a road on the map has no relationship to maintenance responsibility by any level of government.

Address:  
 OKLAHOMA DEPARTMENT OF TRANSPORTATION  
 REPRODUCTION BRANCH Phone (405) 521-2586  
 200 N.E. 21st STREET  
 OKLAHOMA CITY, OKLAHOMA 73105-3204

ALL RIGHTS RESERVED SHEET 2 OF 2 SHEETS COMPUTER GENERATED