



Lake Murray State Park

Experience southern comfort at Oklahoma's first and largest state park, located on the shores of beautiful, crystal-clear Lake Murray.

Enjoy the lodge, which provides the perfect meeting space, ballroom and accommodations for reunions, special events or leadership conferences. Additional lodging includes 58 park cabins for a remote experience.

Lake Murray is an outdoor adventure-seeker's dream. With more than 12,000 acres of forested rolling hills, the park features an 18-hole golf course, ATV trails, horseback riding and more. The landmark Tucker Tower sits high above the bluff, overlooking the spring-fed aqua waters of the lake. Large pavilions scattered throughout the park provide a shady gathering spot for reunions or large groups to relax, enjoy conversation and a meal cooked on the grill.

A drive through the park showcases the rich history that exists within the buildings and structures – the most visible reminders of the work accomplished by the Civilian Conservation Corps when the park was built in the 1930s. Step back into a beautiful reflection of the past and create new memories with your group at Lake Murray State Park.



ACTIVITIES / ATTRACTIONS

- 5,728 ACRE LAKE
- 12,496 PARK ACRES
- 18-HOLE GOLF COURSE/PAR 72
- PRO SHOP/ON-SITE PGA PRO
- FISHING/BOATING/WATERSPORTS
- TUCKER TOWER HISTORICAL MUSEUM
- LAKE MURRAY NATURE CENTER
- NATURE PROGRAMS/NATURALIST
- PAVED ACCESSIBLE MULTI-USE TRAIL
- GUIDED TRAIL RIDES & STABLE HAYRIDES
- WATER SPORTS & MINIATURE GOLF
- LAKE CRUISES/WATERCRAFT RENTALS
- SWIMMING POOL & SPLASH PAD
- ATV/MOTORCYCLE TRAILS
- MARINA/BOAT RENTALS
- HISTORIC STRUCTURES BUILT BY THE CIVILIAN CONSERVATION CORPS IN THE 1930S

AMENITIES

- MAIN LODGE (16-PLEX/SLEEPS 64)
- POD A (8-PLEX/SLEEPS 32)
- POD B (8-PLEX/SLEEPS 32)
- 58 CABINS WITH KITCHENETTES
- SOME WITH FIREPLACES
- 9 CAMPGROUNDS
- ONLINE RV RESERVATIONS SITE
WWW.TRAVELOK.COM
- 2 GROUP CAMPS – SEASONAL
- GROUP CAMPGROUND
- 330 RV/300 CAMPSITES
- GIFT SHOP
- ROAD RUNNER FITNESS CENTER
- WIFI AVAILABLE IN LODGE

MEETING GROUP / FACILITIES

- 8 MEETING ROOMS AVAILABLE
- + PRE-FUNCTION AREAS
- BALD EAGLE RECEPTION HALL (4186 S.F.) (3 BREAKOUT ROOMS)
- BANQUET CATERING
- GROUP PICNIC PAVILIONS W/GRILLS

AUDIO / VIDEO EQUIPMENT

- SOUND SYSTEM
- SMART TVS WITH VIDEO PLAYER
- DIGITAL PROJECTOR/
PROJECTION SCREENS
- PORTABLE STAGES
- PODIUMS
- EASELS

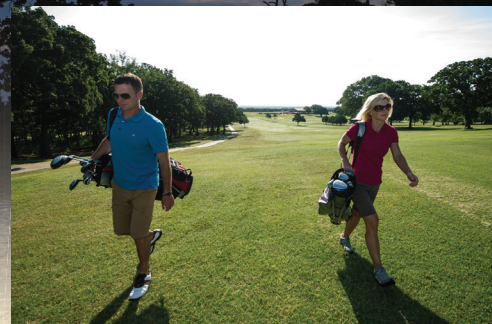
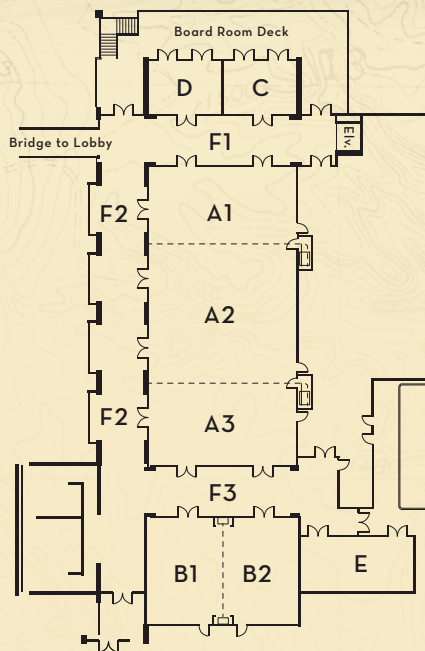

ROOM DIMENSIONS

		Dimensions	Sq. Ft.	Theater	Classroom	Conference	U-Shape	Rounds	Banquet
A	Bald Eagle Reception Hall	45'7"x91'6"	4186	480	280	N/A	N/A	280	360
	Section 1	45'7"x24'2"	1106	140	70	40	35	60	114
	Section 2	45'7"x42'	1919	190	120	58	50	96	170
	Section 3	45'7"x25'4"	1160	150	80	45	40	66	124
B	Hummingbird Mtg. Room	46'x32'4"	1490	140	100	50	50	100	112
	Section 1	23'x32'4"	745	70	50	28	25	50	60
	Section 2	23'x32'4"	745	70	50	28	25	50	60
C	Mallard Board Room	22'x15'10"	332	N/A	N/A	14	N/A	N/A	N/A
D	Gadwall Board Room	22'x15'10"	332	N/A	N/A	14	N/A	N/A	N/A
E	Oriole Hospitality Room	17'2"x34'2"	588	50	35	24	18	30	45
F1	Pre-Function Area East (Lake)	12'8"x46'1"							
F2	Pre-Function Area North	13'x132'10"	Area will accommodate 16 - 8ft vendor tables						
F3	Pre-Function Area West	14'6"x47'7"							

OKLAHOMA STATE PARKS

123 ROBERT S. KERR
OKLAHOMA CITY, OK 73102
OSPCUSTOMERSERVICE@TRAVELOK.COM
405-522-9986

LAKE MURRAY STATE PARK IS LOCATED HALFWAY BETWEEN
OKLAHOMA CITY AND DALLAS, 2 MILES EAST OF I-35 AT EXIT 24.

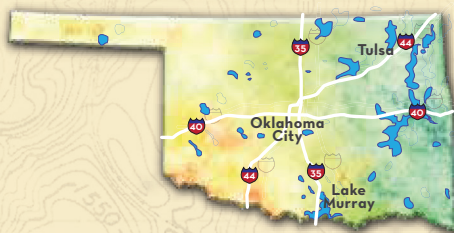

LAKE MURRAY LODGE

3323 LODGE ROAD
ARDMORE, OK 73401
RESERVATIONS: 800-257-0322
580-223-6600
PARK OFFICE: 580-223-4044
PRO SHOP: 580-223-6613
LAKEMURRAYRESORT@TRAVELOK.COM

OKLAHOMA
STATE PARKS

ONLINE RESERVATIONS AVAILABLE AT
TRAVELOK.COM